

固定端不可动
Fixed bracket
cannot be moved

高稳定性:大尺寸销“按钮”高夹紧力
Big shaft plug for high stability

长寿命:横向滑动面
horizontal sliding section for longer life

长架空行程:双限位块
Double stop dogs for long unsupported travel

通用:许多安装选项,带或不带梳妆片
Many options with/
without tie-wrap clamp.

活动端可旋转
Moving bracket can be rotated

横杆可沿内部或外部半径打开
Cross bar can be opened
along inner radius or outer radius

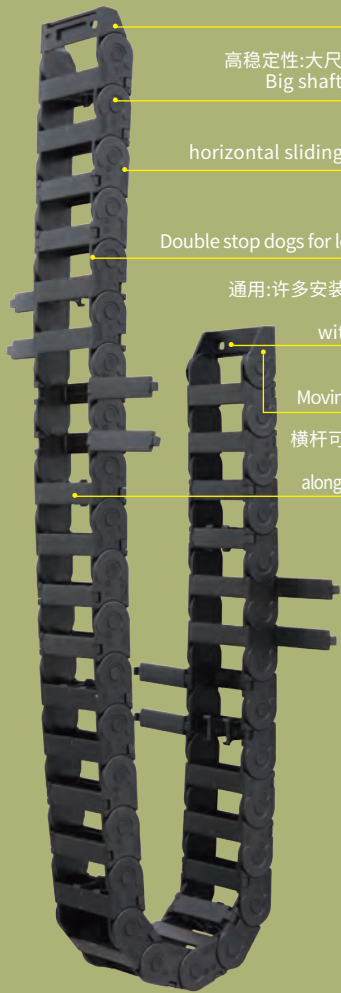

LIGHTWEIGHT

Lightweight Type-EN·EW
Cable Chain

轻便型EN·EW系列拖链

轻便型 EN·EW 系列拖链

Lightweight Type-EN·EW Series Cable Chain

价格指数 Price index



可根据客户需求提供防火材料
Fire-proof materials are available if customized

可根据客户需求提供防静电材料
Anti-static materials are available if customized

功能特点 Features & Benefits

- 横杆在内侧或外侧均可打开
- 节距小, 噪音低
- 阻燃等级 UL94 V-2
- 配有整体式带梳状片接头
- 外形设计美观、大方
- 耐摩擦、耐腐蚀, 滑行应用
- 可以组装成“S”型拖链
- Cross bars can be opened along inwards or outwards radius
- Small pitch, low noise
- Flammability class UL94 V-2
- Integrated bracket with tie-wrap clamp optional
- Beautiful and decent appearance design
- Anti-corrosion, Rub-resistance, Gliding application
- Assembled as S-shaped chain

便于拆装 Easy disassembly

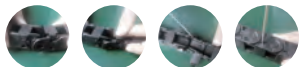

装 Install 拆 dismantle

轻便型拖链的适用场合 Application

- 低负荷场合应用
- 行程 ≤ 150m
- For low loading
- Travel distance ≤ 150m

轻便型拖链的不适用场合 Not applicable

- 环境比较恶劣
- 超重载荷运行
- The environment is more bad
- Not for overloading operation

订购示例-整条拖链 Order details

请注明拖链长度或者链节数 如: 1米或30节
EN2125*R38*1000*2 (2条长度1米的拖链, 内开盖)

Please mark the length or link number, such as 1 meter or 30 links
EN2125*R38*1000*2 (2 pieces of 1-meter-long cable chain, cover open along inner radius)

EN2125*B*T1*1 (1副接头, T1安装方式)

EN2125*B*T1*1 (1 piece of connector, T1 installation method)

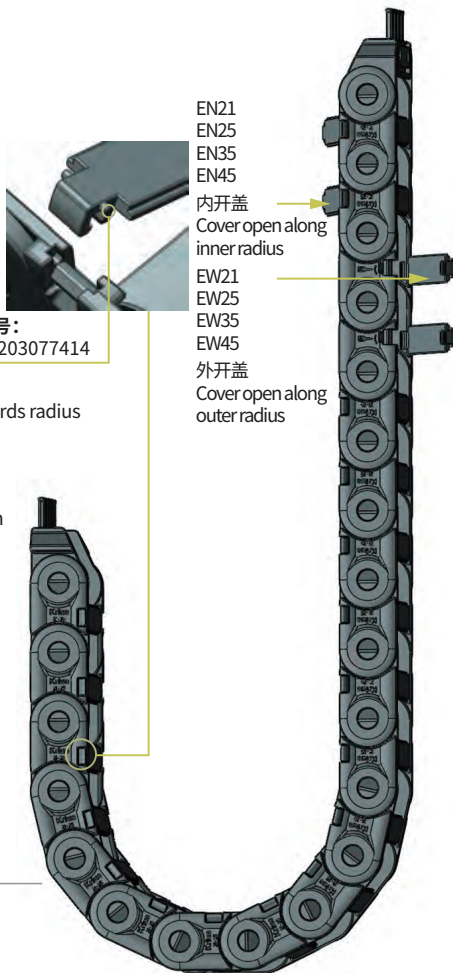

EN21·EW21 拖链-安装尺寸及技术参数

EN21·EW21 Cable Chain-Installation Dimensions and Technical Parameters

架空长度 Unsupported length

- LG=直线架空长度
- LA=安全塌腰架空长度
- LG=Unsupported with straight upper run
- LA=Unsupported with permitted sag

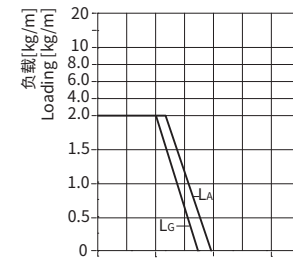
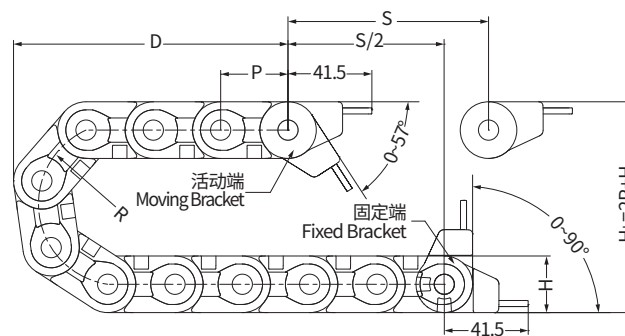
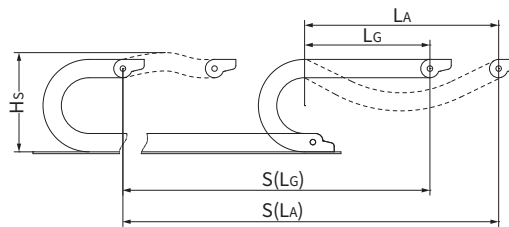

行程长度 S [m]
Length of travel S [m]

- S = 行程长度
- R = 弯曲半径
- P = 节距
- L = 拖链长度
- N = 每米链节数
- HL = 理论安装高度
- Hs = 实际安装高度
- D = 拖链返回极限位置时的最小距离
- K = $\pi \cdot R + 2P$
- * K值可在科瑞斯相关表格中直接查询

- S = Length of travel
- R = Bending radius
- P = Pitch
- L = Length of chain
- N = Links per meter
- HL = Nominal clearance height
- Hs = Required clearance height
- D = Overlength energy chain radius in final position
- K = $\pi \cdot R + 2P$
- * You can find it from below chart for more details

R	HL	D	K	P
mm (in.)	mm (in.)	mm (in.)	mm (in.)	mm (in.)
35 (1.38)	98 (3.86)	80 (3.15)	165 (6.50)	33.3 (1.31)
38 (1.50)	104 (4.09)	86 (3.39)	175 (6.89)	33.3 (1.31)
48 (1.90)	124 (4.88)	106 (4.17)	205 (8.07)	33.3 (1.31)
75 (2.95)	178 (7.01)	160 (6.30)	290 (11.42)	33.3 (1.31)
100 (3.94)	228 (8.98)	210 (8.27)	370 (14.57)	33.3 (1.31)
125 (4.92)	278 (10.94)	260 (10.24)	450 (17.72)	33.3 (1.31)
145 (5.71)	318 (12.52)	300 (11.81)	510 (20.08)	33.3 (1.31)
180 (7.09)	388 (15.28)	370 (14.57)	620 (24.41)	33.3 (1.31)

实际安装高度: Hs=HL+20mm
拖链长度: L=S/2+K (固定端在中间)
每米链节数: N=30 (990mm)

The required clearance height: Hs=HL+0.79in.
Chain length: L=S/2+K (Fixed end in the middle)
Links per meter: N=30 (38.98 in.)

技术参数 Technical Parameters		
速度/加速度 Lg	Speed/acceleration Lg	max.20[m/s]/max.200[m/s ²]
速度/加速度 LA	Speed/acceleration Lg	max.3[m/s]/max.6[m/s ²]
滑行速度/加速度	Gliding speed/acceleration	max.12[m/s]/max.50[m/s ²]
材料-允许温度 °C	Material-permitted temperature	Reinforce PA/-40°C至+125°C
阻燃等级, 增强尼龙	Flammability Class, Reinforce PA	UL94 V-2

EN21·EW21 拖链-产品规格范围 EN21·EW21 Cable Chain-Product specifications

EN21·EW21拖链-内侧或外侧均可打开 EN21·EW21 Cable Chain-Inner or outer can be opened

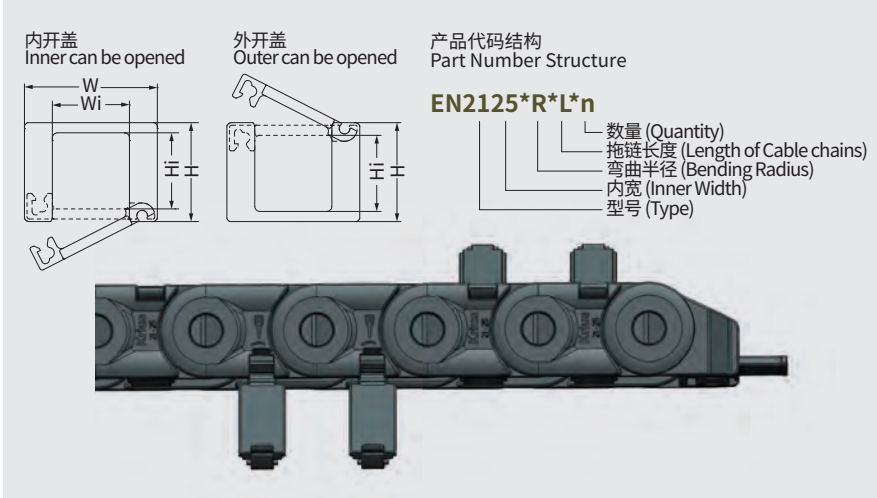

型号 Type	弯曲半径<R> Bending radius	内高<Hi> Inner height	内宽<Wi> Inner width	外高<H> Outer height	外宽<W> Outer Width	重量<G> Weight	备注 Remark
	mm (in.)	mm (in.)	mm (in.)	mm (in.)	mm (in.)	kg/m (lbs/ft)	
EN2125 EW2125			25.2 (0.99)		37.8 (1.49)	0.42 (0.29)	
EN2138 EW2138			38.2 (1.50)		50.8 (2.00)	0.45 (0.31)	
EN2150 EW2150			50.2 (1.98)		62.8 (2.47)	0.50 (0.34)	
EN2168 EW2168		21 (0.83)	68.2 (2.69)	28 (1.10)	80.8 (3.18)	0.75 (0.51)	
EN2180 EW2180			80.2 (3.16)		92.8 (3.65)	0.96 (0.65)	
EN21100 EW21100			100.2 (3.94)		112.8 (4.44)	1.02 (0.69)	
EN21125 EW21125			125.2 (4.93)		137.8 (5.53)	1.32 (0.90)	

订货范例 Order details **EN2125 * R75 * 1000mm * 2**

R	H _L	D	K	P
mm (in.)	mm (in.)	mm (in.)	mm (in.)	mm (in.)
35 (1.38)	98 (3.86)	80 (3.15)	165 (6.50)	33.3 (1.31)
38 (1.50)	104 (4.09)	86 (3.39)	175 (6.89)	33.3 (1.31)
48 (1.90)	124 (4.88)	106 (4.17)	205 (8.07)	33.3 (1.31)
75 (2.95)	178 (7.01)	160 (6.30)	290 (11.42)	33.3 (1.31)
100 (3.94)	228 (8.98)	210 (8.27)	370 (14.57)	33.3 (1.31)
125 (4.92)	278 (10.94)	260 (10.24)	450 (17.72)	33.3 (1.31)
145 (5.71)	318 (12.52)	300 (11.81)	510 (20.08)	33.3 (1.31)
180 (7.09)	388 (15.28)	370 (14.57)	620 (24.41)	33.3 (1.31)

EN21·EW21 拖链-拖链接头 EN21·EW21 Cable Chain-Mounting Bracket

塑料接头, 整体式 Plastic Mounting Bracket, Integrated type

- 整体式接头
- 耐腐蚀 & 耐摩擦
- 可提供预装配形式
- 可实现内外连接
- Integrated type Mounting Bracket
- Anti-corrosion, Rub-resistance
- Available preassembly form
- Can realize the internal and external connections



可选配的接头安装方式 Available installation methods

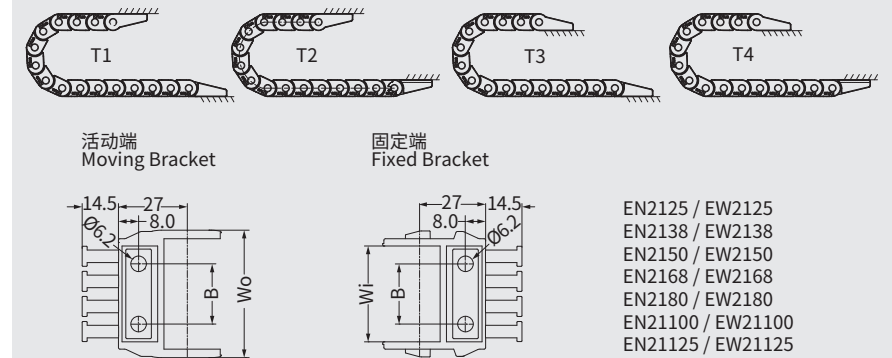

拖链型号 Type	拖链编码 Code	主体编码 Main Body Code	接头编码 Mounting Bracket Code	Wo尺寸 Dimension Wo	B尺寸 Dimension B
				mm (in.)	mm (in.)
EN2125	EW2125	14231	14229	14230	37.8 (1.49) / 13 (0.51)
EN2138	EW2138	14234	14232	14233	50.8 (2.00) / 24 (0.94)
EN2150	EW2150	14237	14235	14236	62.8 (2.47) / 36 (1.42)
EN2168	EW2168	14240	14238	14239	80.8 (3.18) / 54 (2.13)
EN2180	EW2180	14243	14241	14242	92.8 (3.65) / 66 (2.60)
EN21100	EW21100	14246	14244	14245	112.8 (44.4) / 86 (3.39)
EN21125	EW21125	14249	14247	14248	137.8 (5.53) / 111 (4.37)

产品代码结构 Part Number Structure

EN2125*B*T1

- 安装方式 (Installation Methods)
- 两端接头 (On Both Brackets)
- 内宽 (Inner Width)
- 型号 (Type)

- EN2125*B*T1*n 两端接头
On both brackets
- EN2125*f*T1*n 固定端接头
Fixed bracket
- EN2125*m*T1*n 活动端接头
Moving bracket

★ 每款拖链的接头都有所不同, 订购时如有任何疑问, 请及时咨询科瑞斯。
Every bracket is different, please contact us if you have any question.

EN21·EW21 拖链-隔离片 EN21·EW21 Cable Chain-Separator

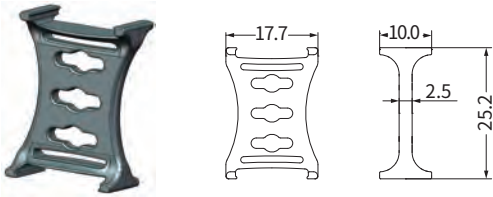

EN21·EW21拖链隔离片编码:14250
The separator No. for EN21·EW21:14250

- 本款拖链有竖隔片和横隔片供客户选配,均为尼龙材质,可实现水平分隔和/或垂直分隔
- 竖隔片的数量可以根据客户的实际需求进行配备,可以每隔一个链节装一个,也可以每隔一个链节装几个,客户可任意配备
- 竖隔片安装完成后,可以根据线缆排布进行滑动
- Vertical and horizontal two kinds of separator are available to choose, both are Nylon and for vertical and/or horizontal division.
- Vertical separators can be placed into each link or different quantity links, it can be customized
- Separators can be moved for different cable

EN25·EW25 拖链-安装尺寸及技术参数 EN25·EW25 Cable Chain-Installation Dimensions and Technical Parameters

架空长度

Unsupported length

- L_G = 直线架空长度 · L_G = Unsupported with straight upper run
- L_A = 安全塌腰架空长度 · L_A = Unsupported with permitted sag

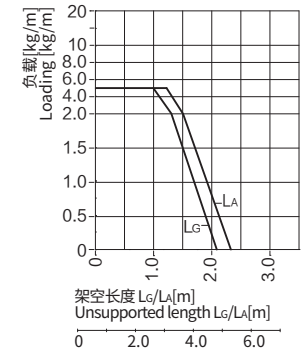
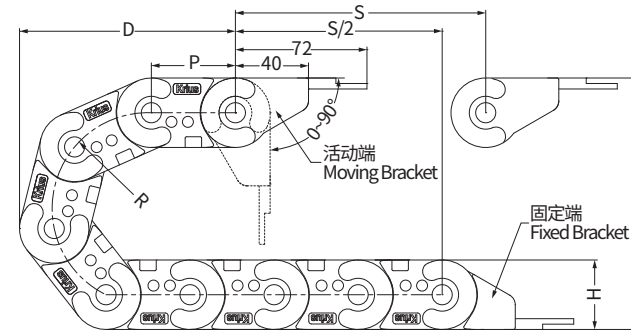
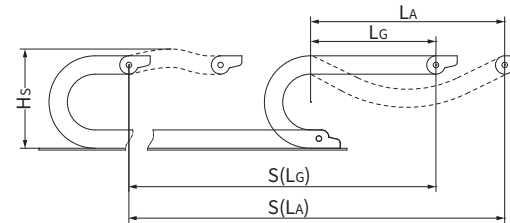

架空长度 L_G/L_A[m]
Unsupported length L_G/L_A[m]

行程长度 S[m]
Length of travel S[m]

- S = 行程长度
- R = 弯曲半径
- P = 节距
- L = 拖链长度
- N = 每米链节数
- H_L = 理论安装高度
- H_s = 实际安装高度
- D = 拖链返回极限位置时的最小距离
- K = $\sqrt{L \cdot R} + 2P$
- * K值可在科瑞斯相关表格中直接查询
- S = Length of travel
- R = Bending radius
- P = Pitch
- L = Length of chain
- N = Links per meter
- H_L = Nominal clearance height
- H_s = Required clearance height
- D = Overlength energy chain radius in final position
- K = $\sqrt{L \cdot R} + 2P$
- * You can find it from below chart for more details

R	H _L	D	K	P
mm (in.)	mm (in.)	mm (in.)	mm (in.)	mm (in.)
50 (1.97)	138 (5.43)	110 (4.33)	249 (9.80)	46 (1.81)
75 (2.95)	188 (7.40)	160 (6.30)	330 (12.99)	46 (1.81)
100 (3.94)	238 (9.37)	210 (8.27)	405 (15.94)	46 (1.81)
125 (4.92)	288 (11.34)	260 (10.24)	485 (19.09)	46 (1.81)
150 (5.91)	338 (13.31)	310 (12.20)	565 (22.24)	46 (1.81)
200 (7.87)	438 (17.24)	410 (16.14)	720 (28.36)	46 (1.81)

实际安装高度: H_s=H_L+35mm

拖链长度: L=S/2+K (固定端在中间)

每米链节数: N=22 (1012mm)

The required clearance height: H_s=H_L+1.38in.

Chain length: L=S/2+K (Fixed end in the middle)

Links per meter: N=22 (39.84 in.)

技术参数 Technical Parameters		
速度/加速度 L _G	Speed/acceleration L _G	max.20[m/s]/max.200[m/s ²]
速度/加速度 L _A	Speed/acceleration L _A	max.3[m/s]/max.6[m/s ²]
滑行速度/加速度	Gliding speed/acceleration	max.12[m/s]/max.50[m/s ²]
材料-允许温度°C	Material-permitted temperature	Reinforce PA/-40°C至+125°C
阻燃等级, 增强尼龙	Flammability Class, Reinforce PA	UL94V-2

EN25·EW25 拖链-产品规格范围 EN25·EW25 Cable Chain-Product specifications

EN25·EW25拖链-内侧或外侧均可打开 EN25·EW25 Cable Chain-Inner or outer can be opened

内开盖
Inner can be opened

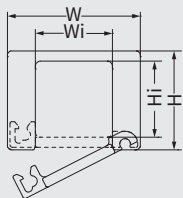

外开盖
Outer can be opened

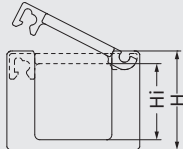

产品代码结构
Part Number Structure

EN2525*R*L*n

数量 (Quantity)
拖链长度 (Length of Cable chains)
弯曲半径 (Bending Radius)
内宽 (Inner Width)
型号 (Type)

注:拖链在内侧打开 (EN25系列) 和在外侧打开 (EW25) 为两款拖链, 订购时请注明
EN25 and EW25 are different item, please note when order



型号 Type	弯曲半径<R> Bending radius	内高<Hi> Inner height	内宽<Wi> Inner width	外高<H> Outer height	外宽<W> Outer Width	重量<G> Weight	备注 Remark
	mm (in.)	mm (in.)	mm (in.)	mm (in.)	mm (in.)	kg/m (lbs/ft)	
EN2525	EW2525		25.3 (1.00)		42.7 (1.68)	0.84 (0.57)	
EN2538	EW2538		38.3 (1.51)		55.7 (2.19)	0.91 (0.62)	
EN2550	EW2550	25.4 (1.00)	50.3 (1.98)	38 (1.50)	67.7 (2.67)	0.95 (0.65)	
EN2557	EW2557		57.3 (2.26)		74.7 (2.94)	1.00 (0.68)	
EN2577	EW2577		77.3 (3.04)		94.7 (3.73)	1.17 (0.80)	

订货范例
Order details

EN2525 * R100 * 1000mm * 2

R	H _L	D	K	P
mm (in.)	mm (in.)	mm (in.)	mm (in.)	mm (in.)
50 (1.97)	138 (5.43)	110 (4.33)	249 (9.80)	46 (1.81)
75 (2.95)	188 (7.40)	160 (6.30)	330 (12.99)	46 (1.81)
100 (3.94)	238 (9.37)	210 (8.27)	405 (15.94)	46 (1.81)
125 (4.92)	288 (11.34)	260 (10.24)	485 (19.09)	46 (1.81)
150 (5.91)	338 (13.31)	310 (12.20)	565 (22.24)	46 (1.81)
200 (7.87)	438 (17.24)	410 (16.14)	720 (28.36)	46 (1.81)

EN25·EW25 拖链-拖链接头 EN25·EW25 Cable Chain-Mounting Bracket

塑料接头, 整体式 Plastic Mounting Bracket, Integrated type

- 整体式接头
- 耐腐蚀&耐摩擦
- 可提供预装配形式
- 可实现内外连接
- Integrated type Mounting Bracket
- Anti-corrosion, Rub-resistance
- Available preassembly form
- Can realize the internal and external connections

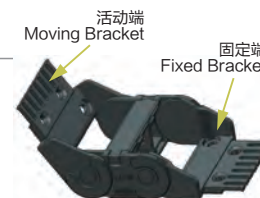

可选配的接头安装方式 Available installation methods

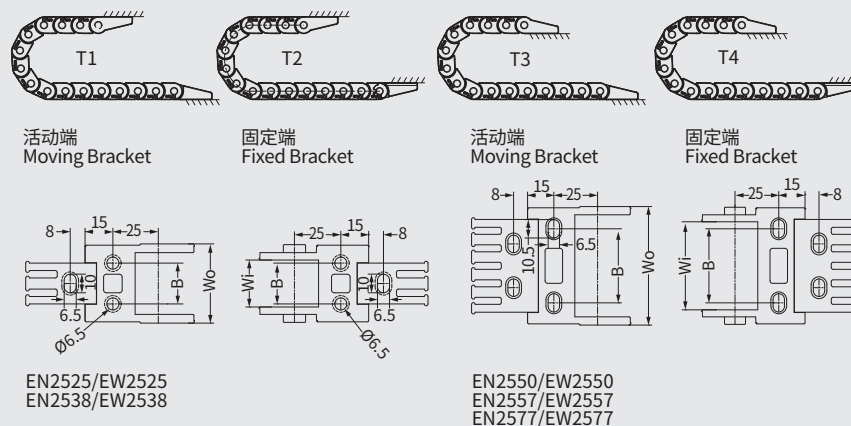

拖链型号 Type	拖链编码 Code	主体编码 Main Body Code	接头编码 Mounting Bracket Code	Wo尺寸 Dimension Wo	B尺寸 Dimension B
				mm (in.)	mm (in.)
EN2525	EW2525	13115	13105	42.7 (1.68)	22.2 (0.87)
EN2538	EW2538	13116	13107	55.7 (2.19)	35.2 (1.39)
EN2550	EW2550	13117	13109	67.7 (2.67)	42.3 (1.67)
EN2557	EW2557	13118	13111	74.7 (2.94)	47.8 (1.88)
EN2577	EW2577	13119	13113	94.7 (3.73)	67.8 (2.67)

产品代码结构 Part Number Structure

EN2525*B*T1

安装方式 (Installation Methods)
两端接头 (On Both Brackets)
内宽 (Inner Width)
型号 (Type)

EN2525*B*T1*n 两端接头
On both brackets
EN2525*f*T1*n 固定端接头
Fixed bracket
EN2525*m*T1*n 活动端接头
Moving bracket

★ 每款拖链的接头都有所不同, 订购时如有任何疑问, 请及时咨询科瑞斯。
Every bracket is different, please contact us if you have any question.

EN25·EW25 拖链-梳状板 EN25·EW25 Cable Chain-Tie-wrap plate



梳状板为独立部件, 可根据需要进行选配
Tie-wrap is spare part independent, you can mark use or not when order

选配代码结构
Part Number Structure

EN/EW25+S25

梳状板型号 (Type of Tie-wrap plate)
拖链型号 (Type of Cable Chain)

梳状板型号 Type of Tie-wrap plate	适用拖链内宽 Inner width	尺寸A Dimension A	尺寸B Dimension B	齿数 Teeth NO.	编码 Code
S25	25	22 (0.87)	-	3	11131
S38	38	34 (1.34)	15 (0.59)	4	11131
S57	50/57	53 (2.09)	25 (0.89)	6	11132
S77	77	73 (2.87)	41 (1.61)	8	11133

EN25·EW25 拖链-隔离片 EN25·EW25 Cable Chain-Separator



EN25·EW25拖链隔离片编码: 13120
The separator No. for EN25·EW25: 13120

- 本款拖链有竖隔片和横隔片供客户选配, 均为尼龙材质, 可实现水平分隔和/或垂直分隔
- 竖隔片的数量可以根据客户的实际需求进行配备, 可以每隔一个链节装一个, 也可以每隔一个链节装几个, 客户可任意配备
- 竖隔片安装完成后, 可以根据线缆排布进行滑动
- Vertical and horizontal two kinds of separator are available to choose, both are Nylon and for vertical and / or horizontal division.
- Separator separators can be placed into each link or different quantity links, it can be customized
- Separators can be moved for different cable

EN35·EW35 拖链-安装尺寸及技术参数 EN35·EW35 Cable Chain-Installation Dimensions and Technical Parameters

架空长度 Unsupported length

- L_G = 直线架空长度 · L_G = Unsupported with straight upper run
- L_A = 安全塌腰架空长度 · L_A = Unsupported with permitted sag

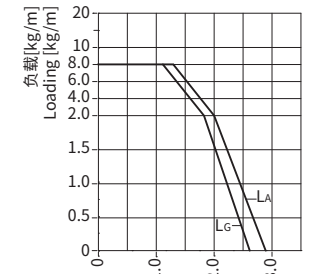
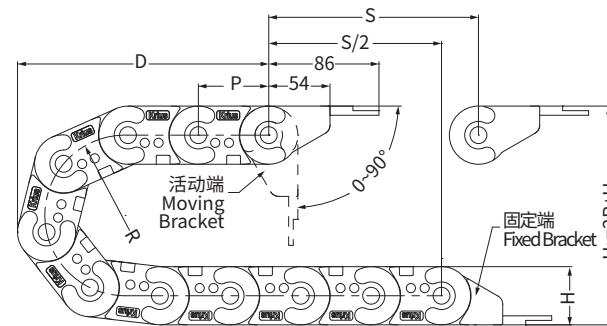
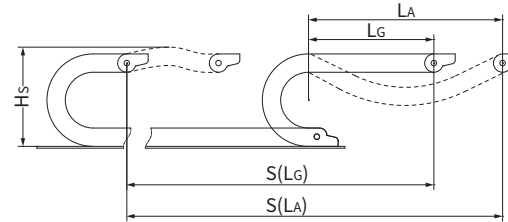

架空长度 L_G/L_A[m]
Unsupported length L_G/L_A[m]

行程长度 S[m]
Length of travel S[m]

- S = 行程长度
- R = 弯曲半径
- P = 节距
- L = 拖链长度
- N = 每米链节数
- H_L = 理论安装高度
- H_S = 实际安装高度
- D = 拖链退回板限位时的最小距离
- K = l · R + 2P
- * K值可在科瑞斯相关表格中直接查询
- S = Length of travel
- R = Bending radius
- P = Pitch
- L = Length of chain
- N = Links per meter
- H_L = Nominal clearance height
- H_S = Required clearance height
- D = Overlength energy chain radius in final position
- K = l · R + 2P
- * You can find it from below chart for more details

R	H _L	D	K	P
mm (in.)	mm (in.)	mm (in.)	mm (in.)	mm (in.)
63 (2.17)	180 (7.09)	136 (5.35)	310 (12.20)	56 (2.20)
75 (2.95)	204 (8.03)	160 (6.30)	350 (13.78)	56 (2.20)
100 (3.94)	254 (10.00)	210 (8.27)	425 (16.73)	56 (2.20)
125 (4.92)	304 (11.97)	260 (10.24)	505 (19.88)	56 (2.20)
150 (5.91)	354 (13.94)	310 (12.20)	585 (23.03)	56 (2.20)
175 (6.89)	404 (15.91)	360 (14.17)	660 (25.98)	56 (2.20)
200 (7.87)	454 (17.87)	410 (16.14)	740 (29.13)	56 (2.20)
250 (9.84)	554 (21.81)	510 (20.08)	895 (35.24)	56 (2.20)
300 (11.81)	654 (25.75)	610 (24.02)	1055 (41.54)	56 (2.20)

实际安装高度: H_S = H_L + 50mm
拖链长度: L = S/2 + K (固定端在中间)
每米链节数: N = 18 (1008mm)

The required clearance height: H_S = H_L + 1.97in.
Chain length: L = S/2 + K (Fixed end in the middle)
Links per meter: N = 18 (39.69 in.)

技术参数 Technical Parameters		
速度/加速度 L _G	Speed/acceleration L _G	max.20[m/s]/max.200[m/s ²]
速度/加速度 L _A	Speed/acceleration L _A	max.3[m/s]/max.6[m/s ²]
滑行速度/加速度	Gliding speed/acceleration	max.5[m/s]/max.12[m/s ²]
材料-允许温度 °C	Material-permitted temperature	Reinforce PA / -40°C至+125°C
阻燃等级, 增强尼龙	Flammability Class, Reinforce PA	UL94 V-2

EN35·EW35 拖链-产品规格范围

EN35·EW35 Cable Chain-Product specifications

EN35·EW35拖链-内侧或外侧均可打开 EN35·EW35 Cable Chain-Inner or outer can be opened

内开盖
Inner can be opened

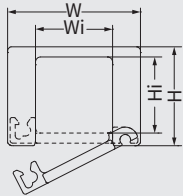

外开盖
Outer can be opened

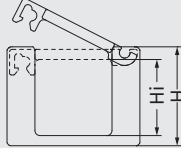

产品代码结构
Part Number Structure

EN3550*R*L*n

数量 (Quantity)
拖链长度 (Length of Cable chains)
弯曲半径 (Bending Radius)
内宽 (Inner Width)
型号 (Type)

注:拖链在内侧打开 (EN35系列) 和在外侧打开 (EW35)
为两款拖链,订购时请注明
EN35 and EW35 are different item, please note when order

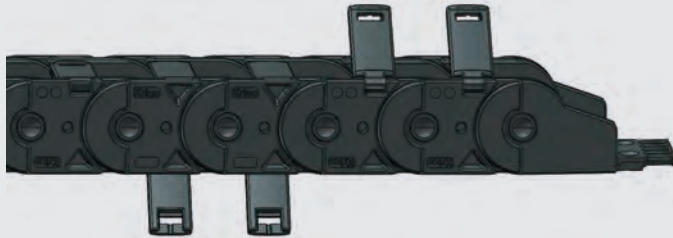

型号 Type	弯曲半径<R> Bending radius	内高<Hi> Inner height	内宽<Wi> Inner width	外高<H> Outer height	外宽<W> Outer Width	重量<G> Weight	备注 Remark
	mm (in.)	mm (in.)	mm (in.)	mm (in.)	mm (in.)	kg/m (lbs/ft)	
EN3550	EW3550			50 (1.97)	75 (2.95)	1.80 (1.22)	
EN3575	EW3575	35.7 (1.41)	75 (2.95)	54 (2.13)	100 (3.94)	2.00 (1.36)	
EN35100	EW35100		100 (3.94)		125 (4.92)	2.21 (1.50)	
EN35125	EW35125		125 (4.92)		150 (5.91)	2.43 (2.65)	

订货范例 Order details **EN3550 * R75 * 1000mm * 2**

R	HL	D	K	P
mm (in.)	mm (in.)	mm (in.)	mm (in.)	mm (in.)
63 (2.17)	180 (7.09)	136 (5.35)	310 (12.20)	56 (2.20)
75 (2.95)	204 (8.03)	160 (6.30)	350 (13.78)	56 (2.20)
100 (3.94)	254 (10.00)	210 (8.27)	425 (16.73)	56 (2.20)
125 (4.92)	304 (11.97)	260 (10.24)	505 (19.88)	56 (2.20)
150 (5.91)	354 (13.94)	310 (12.20)	585 (23.03)	56 (2.20)
175 (6.89)	404 (15.91)	360 (14.17)	660 (25.98)	56 (2.20)
200 (7.87)	454 (17.87)	410 (16.14)	740 (29.13)	56 (2.20)
250 (9.84)	554 (21.81)	510 (20.08)	895 (35.24)	56 (2.20)
300 (11.81)	654 (25.75)	610 (24.02)	1055 (41.54)	56 (2.20)

EN35·EW35 拖链-拖链接头

EN35·EW35 Cable Chain-Mounting Bracket

塑料接头, 整体式 Plastic Mounting Bracket, Integrated type

- 整体式接头
- 耐腐蚀 & 耐摩擦
- 可提供预装配形式
- 可实现内外连接
- Integrated type Mounting Bracket
- Anti-corrosion, Rub-resistance
- Available preassembly form
- Can realize the internal and external connections

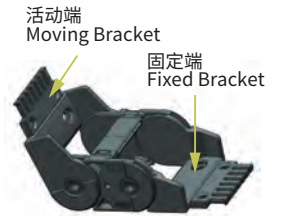

可选配的接头安装方式 Available installation methods

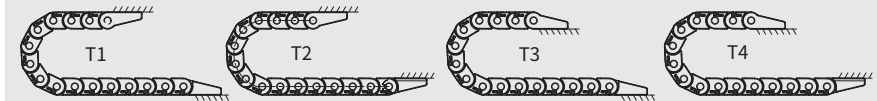

活动端
Moving Bracket

固定端
Fixed Bracket

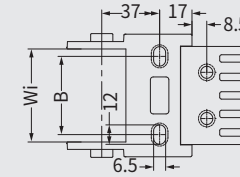
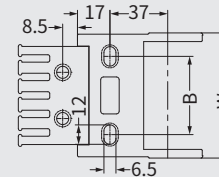

EN3550 / EW3550
EN3575 / EW3575
EN35100 / EW35100
EN35125 / EW35125

拖链型号 Type	拖链编码 Code	主体编码 Main Body Code	接头编码 Mounting Bracket Code	Wo尺寸 Dimension Wo	B尺寸 Dimension B
				mm (in.)	mm (in.)
EN3550	EW3550	13176	13168	13172	75 (2.95) / 30 (1.18)
EN3575	EW3575	13177	13169	13173	100 (3.94) / 55 (2.17)
EN35100	EW35100	13178	13170	13174	125 (4.92) / 80 (3.15)
EN35125	EW35125	13179	13171	13175	150 (5.91) / 105 (4.13)

产品代码结构 Part Number Structure

EN3550*B*T1

安装方式 (Installation Methods)
两端接头 (On Both Brackets)
内宽 (Inner Width)
型号 (Type)

EN3550*B*T1*n 两端接头
On both brackets
EN3550*f*T1*n 固定端接头
Fixed bracket
EN3550*m*T1*n 活动端接头
Moving bracket

★ 每款拖链的接头都有所不同, 订购时如有任何疑问, 请及时咨询科瑞斯。
Every bracket is different, please contact us if you have any question.

EN35·EW35 拖链-梳状板 EN35·EW35 Cable Chain-Tie-wrap plate

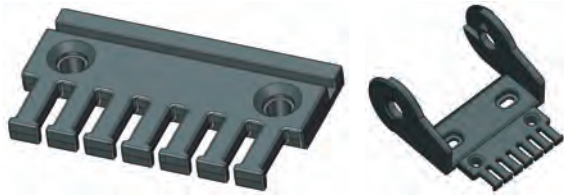

单个梳状板
Single tie-wrap plate

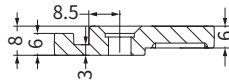

组装图
Shown assembled

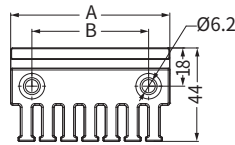
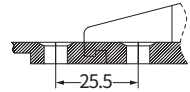

梳状板为独立部件, 可根据需要进行选配
Tie-wrap is spare part independent, you can mark use or not when order

选配代码结构
Part Number Structure

EN/EW35+S50

梳状板型号 (Type of Tie-wrap plate)
拖链型号 (Type of Cable Chain)

梳状板型号 Type of Tie-wrap plate	适用拖链内宽 Inner width	尺寸A Dimension A	尺寸B Dimension B	齿数 Teeth NO.	编码 Code
S50	50	50 (1.97)	30 (1.18)	5	15024
S75	75	75 (2.95)	55 (2.17)	7	15024
S100	100	100 (3.94)	80 (3.15)	10	15025
S125	125	125 (4.92)	105 (4.13)	12	15025

EN35·EW35 拖链-隔离片 EN35·EW35 Cable Chain-Separator

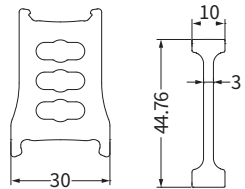
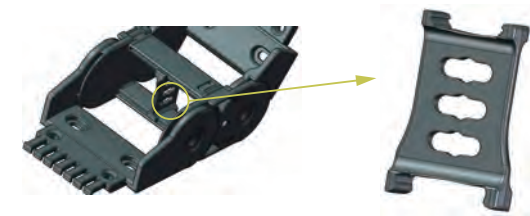

EN35·EW35拖链隔离片编码: 13180
The separator No. for EN35·EW35: 13180

- 本款拖链有竖隔片和横隔片供客户选配, 均为尼龙材质, 可实现水平分隔和/或垂直分隔
- 竖隔片的数量可以根据客户的实际需求进行配备, 可以每隔一个链节装一个, 也可以每隔一个链节装几个, 客户可任意配备
- 竖隔片安装完成后, 可以根据线缆排布进行滑动
- Vertical and horizontal two kinds of separator are available to choose, both are Nylon and for vertical and / or horizontal division.
- Vertical separators can be placed into each link or different quantity links, it can be customized
- Separators can be moved for different cable

EN45·EW45拖链-安装尺寸及技术参数 EN45·EW45 Cable Chain-Installation Dimensions and Technical Parameters

架空长度 Unsupported length

- L_G = 直线架空长度 · L_G = Unsupported with straight upper run
- L_A = 安全塌腰架空长度 · L_A = Unsupported with permitted sag

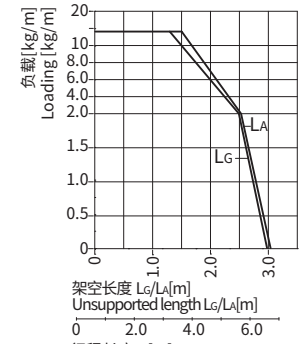
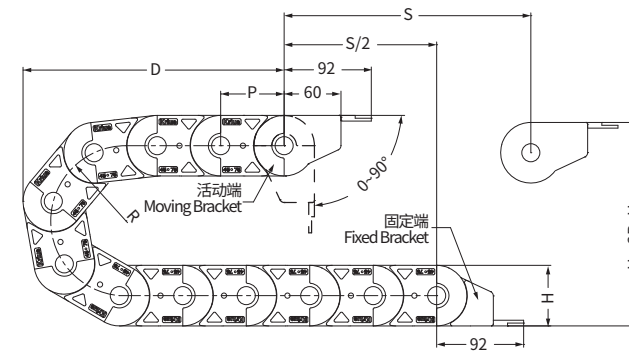
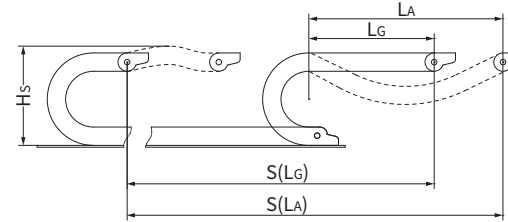

行程长度 S [m]
Length of travel S [m]

S = 行程长度
R = 弯曲半径
P = 节距
L = 拖链长度
N = 每米链节数
HL = 理论安装高度
Hs = 实际安装高度
D = 拖链退回极限位置时的最小距离
K = l · R + 2P

* K值可在科瑞斯相关表格中直接查取
S = Length of travel
R = Bending radius
P = Pitch
L = Length of chain
N = Links per meter
HL = Nominal clearance height
Hs = Required clearance height
D = Overlength energy chain radius in final position
K = l · R + 2P

* You can find it from below chart for more details

R	HL	D	K	P
75 (2.95)	214 (8.43)	160 (6.30)	370 (14.57)	67 (2.64)
100 (3.94)	264 (10.39)	210 (8.27)	450 (17.72)	67 (2.64)
125 (4.92)	314 (12.36)	260 (10.24)	525 (20.67)	67 (2.64)
150 (5.91)	364 (14.33)	310 (12.20)	605 (23.82)	67 (2.64)
200 (7.87)	464 (18.27)	410 (16.14)	760 (29.92)	67 (2.64)
250 (9.84)	564 (22.20)	510 (20.08)	920 (36.22)	67 (2.64)
300 (11.81)	664 (26.14)	610 (24.02)	1075 (42.32)	67 (2.64)

实际安装高度: Hs=HL+50mm
拖链长度: L=S/2+K (固定端在中间)
每米链节数: N=15 (1005mm)

The required clearance height: Hs=HL+1.97in.
Chain length: L=S/2+K (Fixed end in the middle)
Links per meter: N=15 (39.57 in.)

技术参数 Technical Parameters		
速度/加速度 L _G	Speed/acceleration L _G	max.20[m/s]/max.200[m/s ²]
速度/加速度 L _A	Speed/acceleration L _A	max.3[m/s]/max.6[m/s ²]
滑行速度/加速度	Gliding speed/acceleration	max.12[m/s]/max.50[m/s ²]
材料-允许温度 °C	Material-permitted temperature	Reinforce PA/-40°C至+125°C
阻燃等级, 增强尼龙	Flammability Class, Reinforce PA	UL94 V-2

EN45·EW45 拖链-产品规格范围 EN45·EW45 Cable Chain-Product specifications

EN45·EW45拖链-内侧或外侧均可打开 EN45·EW45 Cable Chain-Inner or outer can be opened

内开盖
Inner can be opened

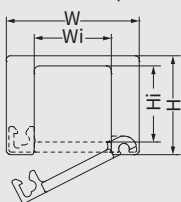

外开盖
Outer can be opened

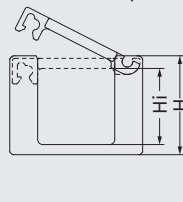

产品代码结构
Part Number Structure

EN4550*R*L*n

数量 (Quantity)
拖链长度 (Length of Cable chains)
弯曲半径 (Bending Radius)
内宽 (Inner Width)
型号 (Type)

注:拖链在内侧打开 (EN45系列) 和在外侧打开 (EW45)
为两款拖链,订购时请注明
EN45 and EW45 are different item, please note when order



型号 Type	弯曲半径<R> Bending radius	内高<H> Inner height	内宽<W> Inner width	外高<H> Outer height	外宽<W> Outer Width	重量<G> Weight	备注 Remark
	mm (in.)	mm (in.)	mm (in.)	mm (in.)	mm (in.)	kg/m (lbs/ft)	
EN4550 EW4550			50 (1.97)		75 (2.95)	1.80 (1.22)	
EN4575 EW4575		45.2(1.78)	75 (2.95)	64 (2.52)	100 (3.94)	1.98 (1.35)	
EN45100 EW45100			100 (3.94)		125 (4.92)	2.23 (1.52)	
EN45125 EW45125			125 (4.92)		150 (5.91)	2.46 (1.67)	

订货范例
Order details

EN4550 * R75 * 1000mm * 2

R	HL	D	K	P
mm (in.)	mm (in.)	mm (in.)	mm (in.)	mm (in.)
75 (2.95)	214 (8.43)	160 (6.30)	370 (14.57)	67 (2.64)
100 (3.94)	264 (10.39)	210 (8.27)	450 (17.72)	67 (2.64)
125 (4.92)	314 (12.36)	260 (10.24)	525 (20.67)	67 (2.64)
150 (5.91)	364 (14.33)	310 (12.20)	605 (23.82)	67 (2.64)
200 (7.87)	464 (18.27)	410 (16.14)	760 (29.92)	67 (2.64)
250 (9.84)	564 (22.20)	510 (20.08)	920 (36.22)	67 (2.64)
300 (11.81)	664 (26.14)	610 (24.02)	1075 (42.32)	67 (2.64)

EN45·EW45 拖链-拖链接头 EN45·EW45 Cable Chain-Mounting Bracket

塑料接头, 整体式 Plastic Mounting Bracket, Integrated type

- 整体式接头
- 耐腐蚀&耐摩擦
- 可提供预装配形式
- 可实现内外连接
- Integrated type Mounting Bracket
- Anti-corrosion, Rub-resistance
- Available preassembly form
- Can realize the internal and external connections

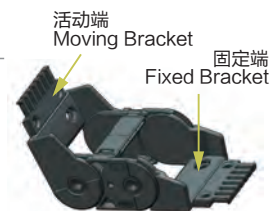

可选配的接头安装方式 Available installation methods

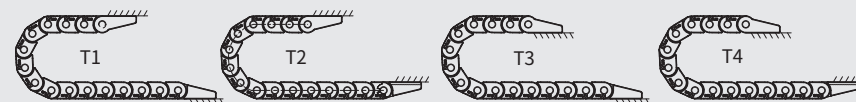

活动端
Moving Bracket

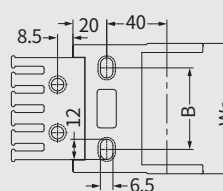

固定端
Fixed Bracket

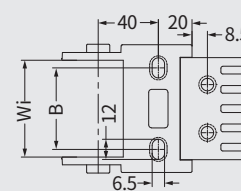

EN4550 / EW4550
EN4575 / EW4575
EN45100 / EW45100
EN45125 / EW45125

拖链型号 Type	拖链编码 Code	主体编码 Main Body Code	接头编码 Mounting Bracket Code	W0尺寸 Dimension W0	B尺寸 Dimension B
				mm (in.)	mm (in.)
EN4550	EW4550	13176	13181	75 (2.95)	28 (1.10)
EN4575	EW4575	13177	13182	100 (3.94)	53 (2.09)
EN45100	EW45100	13178	13183	125 (4.92)	78 (3.07)
EN45125	EW45125	13179	13184	150 (5.91)	103 (4.06)

产品代码结构 Part Number Structure

EN4550*B*T1

安装方式 (Installation Methods)
两端接头 (On Both Brackets)
内宽 (Inner Width)
型号 (Type)

EN4550*B*T1*n 两端接头
On both brackets
EN4550*f*T1*n 固定端接头
Fixed bracket
EN4550*m*T1*n 活动端接头
Moving bracket

★ 每款拖链的接头都有所不同, 订购时如有任何疑问, 请及时咨询科瑞斯。
Every bracket is different, please contact us if you have any question.

EN45·EW45 拖链-梳状板 EN45·EW45 Cable Chain-Tie-wrap plate

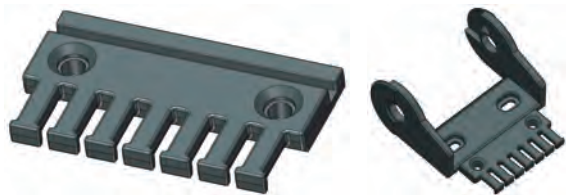

单个梳状板
Single tie-wrap plate

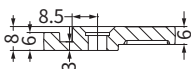

组装图
Shown assembled

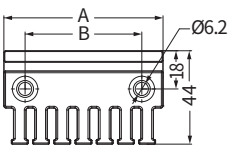
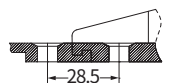

梳状板为独立部件, 可根据需要进行选配
Tie-wrap is spare part independent, you can mark use or not when order

选配代码结构
Part Number Structure

EN/EW45+S50

梳状板型号 (Type of Tie-wrap plate)
拖链型号 (Type of Cable Chain)

梳状板型号 Type of Tie-wrap plate	适用拖链内宽 Inner width	尺寸A Dimension A	尺寸B Dimension B	齿数 Teeth NO.	编码 Code
S50	50	50 (1.97)	30 (1.18)	5	15024
S75	75	75 (2.95)	55 (2.17)	7	15024
S100	100	100 (3.94)	80 (3.15)	10	15025
S125	125	125 (4.92)	105 (4.13)	12	15025

EN45·EW45 拖链-隔离片 EN45·EW45 Cable Chain-Separator



EN45·EW45拖链隔离片编码: 13189
The separator No. for EN45·EW45: 13189

- 本款拖链有竖隔片和横隔片供客户选配, 均为尼龙材质, 可实现水平分隔和/或垂直分隔
- 竖隔片可以根据客户的实际需求进行配备, 可以每隔一个链节装一个, 也可以每隔一个链节装几个, 客户可任意配备
- 竖隔片安装完成后, 可以根据线缆排布进行滑动
- Vertical and horizontal two kinds of separator are available to choose, both are Nylon and for vertical and / or horizontal division.
- Vertical separators can be placed into each link or different quantity links, it can be customized
- Separators can be moved for different cable

K2W.25 拖链-安装尺寸及技术参数 K2W.25 Chain-Installation Dimensions and Technical Parameters

架空长度

Unsupported length

- L_G = 直线架空长度 · L_G = Unsupported with straight upper run
- L_A = 安全塌腰架空长度 · L_A = Unsupported with permitted sag

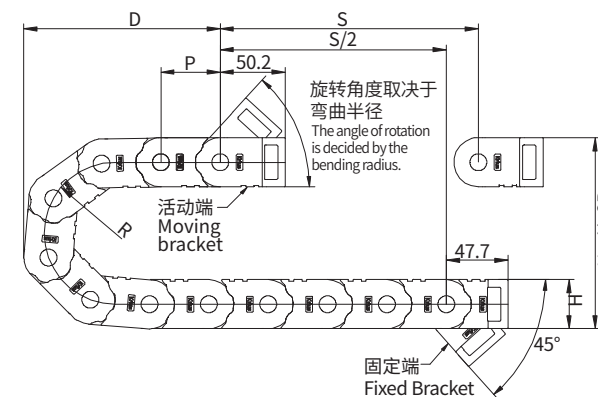
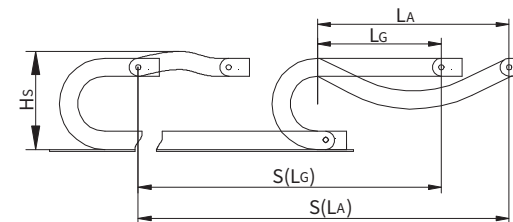

旋转角度取决于
弯曲半径
The angle of rotation
is decided by the
bending radius.

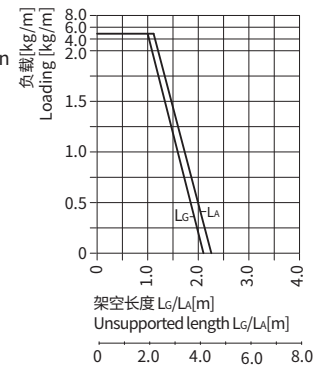

架空长度 L_G/L_A [m]
Unsupported length L_G/L_A [m]

行程长度 S [m]
Length of travel S [m]

- S = 行程长度
- R = 弯曲半径
- P = 节距
- L = 拖链长度
- N = 每米链节数
- H_L = 理论安装高度
- H_S = 实际安装高度
- D = 拖链退回极限位置时的最小距离
- K = π · R + 2P
- * K值可在科瑞斯相关表格中直接查取
- S = Length of travel
- R = Bending radius
- P = Pitch
- L = Length of chain
- N = Links per meter
- H_L = Nominal clearance height
- H_S = Required clearance height
- D = Overlength energy chain radius in final position
- K = π · R + 2P
- * You can find it from below chart for more details

R	H _L	D	K	P
mm (in.)	mm (in.)	mm (in.)	mm (in.)	mm (in.)
55 (2.17)	148 (5.83)	142 (5.59)	265 (10.42)	46 (1.81)

实际安装高度: H_S = H_L + 25mm The required clearance height: H_S = H_L + 0.98in.
拖链长度: L = S/2 + K (固定端在中间) Chain length: L = S/2 + K (Fixed end in the middle)
每米链节数: N = 22 (1012mm) Links per meter: N = 22 (39.85in)

技术参数 Technical Parameters		
速度/加速度 L _G	Speed/acceleration L _G	max.20[m/s]/max.200[m/s ²]
速度/加速度 L _A	Speed/acceleration L _A	max.3[m/s]/max.6[m/s ²]
滑行速度/加速度	Gliding speed/acceleration	max.12[m/s]/max.50[m/s ²]
材料-允许温度 °C	Material-permitted temperature	Reinforce PA/-40°C~+125°C
阻燃等级, 增强尼龙	Flammability Class, Reinforce PA	UL94-HB

K2W.25 拖链-产品规格范围 K2W.25 Cable Chain-Product specifications

K2W.25 拖链-外侧横杆可打开 K2W.25 Cable Chain- Crossbar along the outer radius can be opened

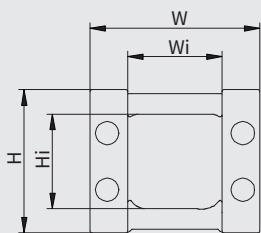

产品代码结构
Part Number Structure

K2W.2525*R*L*n

- 数量 (Quantity)
- 拖链长度 (Length of Cable chains)
- 弯曲半径 (Bending Radius)
- 内宽 (Inner Width)
- 型号 (Type)

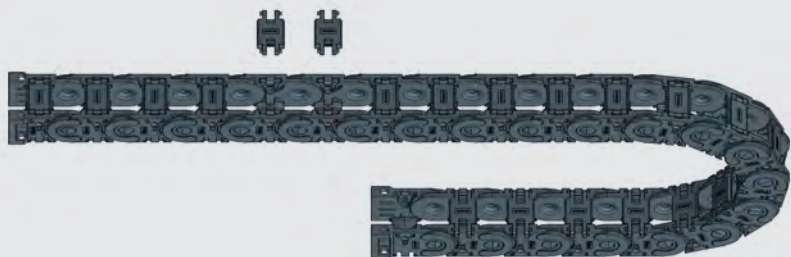

型号 Type	弯曲半径<R> Bending radius	内高<Hi> Inner height	内宽<Wi> Inner width	外高<H> Outer height	外宽<W> Outer Width	重量<G> Weight	备注 Remark
	mm (in.)	mm (in.)	mm (in.)	mm (in.)	mm (in.)	kg/m (lbs/ft)	
K2W.25 25	55	25 (0.98)	25 (0.98)	38 (1.50)	42.4 (1.67)	0.77 (1.70)	

订货范例 Order details **K2W.2525*R55*1000mm*2**

R	HL	D	K	P
mm (in.)	mm (in.)	mm (in.)	mm (in.)	mm (in.)
55 (2.17)	148 (5.83)	142(5.59)	265 (10.42)	46 (1.81)

K2W.25 拖链-拖链接头 K2W.25 Cable Chain-Mounting Bracket

塑料接头或钢制接头 Plastic Or Steel Mounting Bracket

- 双侧独立式塑料接头或钢制接头 · Independent plastic or steel mounting brackets at both ends
- 两侧接头可选择性转动角度 · Optional rotation angle for the mounting brackets at both ends
- 耐腐蚀&耐摩擦 · Anti-corrosion, Rub-resistance
- 可提供预装配件形式 · Available preassembly form
- 可实现内外连接 · Realizable Internal and external connection



可选配的接头安装方式 Available installation methods

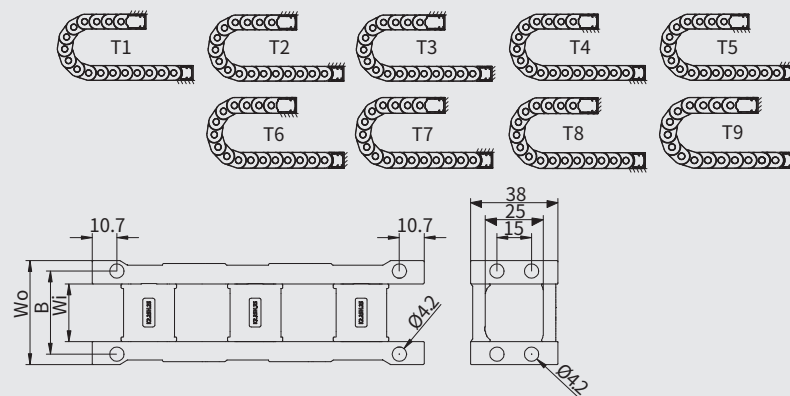

拖链型号 Type	其他编码 Other Code	W0尺寸 Dimension W0	B尺寸 Dimension B
K2W.25 25	主体 Main Body	mm (in.)	mm (in.)
	接头 Mounting Bracket	45 (1.77)	36 (1.42)
	接头 Mounting Bracket		
	横杆 Crossbar		

产品代码结构 Part Number Structure

K2W.2525+B+n

- 安装方式 (Installation Methods)
- 两端接头 (On Both Brackets)
- 内宽 (Inner Width)
- 型号 (Type)

K2W.25*B*T1*n

两端接头
On both brackets

K2W.25*f*T1*n

固定端接头
Fixed bracket

K2W.25*m*T1*n

活动端接头
Moving bracket



每款拖链的接头都有所不同, 订购时如有任何疑问, 请及时咨询科瑞斯。
Every bracket is different, please contact us if you have any question.

K2N.32-K2W.32 拖链-安装尺寸及技术参数

K2N.32-K2W.32 Chain-Installation Dimensions and Technical Parameters

架空长度

Unsupported length

- L_G = 直线架空长度 · L_G = Unsupported with straight upper run
- L_A = 安全塌架空长度 · L_A = Unsupported with permitted sag

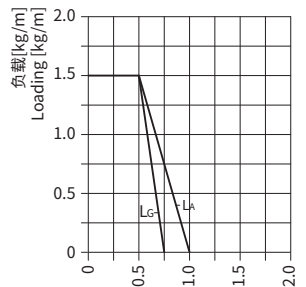
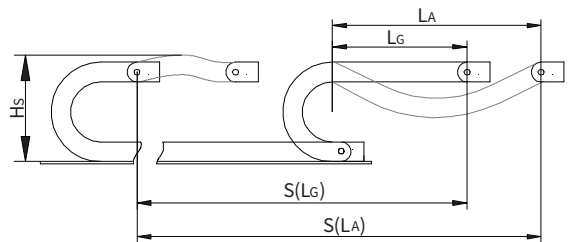

- 架空长度 L_G/L_A[m]
Unsupported length L_G/L_A[m]
- 行程长度 S[m]
Length of travel S[m]
- S = 行程长度
R = 弯曲半径
P = 节距
L = 拖链长度
N = 每米链节数
H_L = 理论安装高度
H_s = 实际安装高度
D = 拖链退回极限位置时的最小距离
K = √L · R + 2P
* K值可在科瑞斯相关表格中直接查询
- S = Length of travel
R = Bending radius
P = Pitch
L = Length of chain
N = Links per meter
H_L = Nominal clearance height
H_s = Required clearance height
D = Overlength energy chain radius in final position
K = √L · R + 2P
* You can find it from below chart for more details

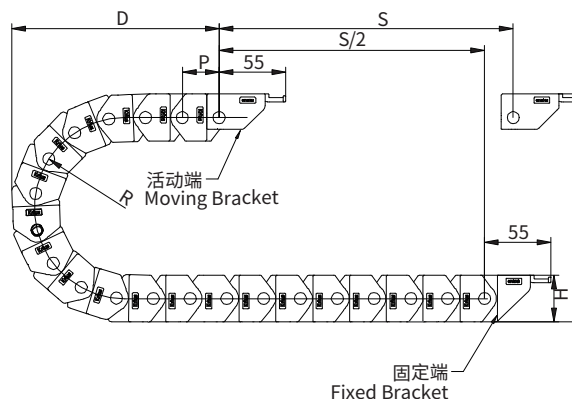

R	H _L	D	K	P
mm (in.)	mm (in.)	mm (in.)	mm (in.)	mm (in.)
48 (1.89)	135 (5.31)	113(4.45)	211.72 (8.34)	30.5 (1.20)
63 (2.48)	165 (6.50)	128(5.04)	258.82 (10.19)	30.5 (1.20)
75 (2.95)	189 (7.44)	140(5.51)	296.5 (11.67)	30.5 (1.20)
100 (3.94)	239 (9.41)	165(6.50)	375 (14.76)	30.5 (1.20)
125 (4.92)	289 (11.38)	190(7.48)	453.5 (17.85)	30.5 (1.20)

实际安装高度: H_s = H_L + 25mm The required clearance height: H_s = H_L + 0.98in.

拖链长度: L = S/2 + K (固定端在中间) Chain length: L = S/2 + K (Fixed end in the middle)

每米链节数: N = 33 (1006mm) Links per meter: N = 33 (39.6in)

技术参数 Technical Parameters		
速度/加速度 L _G	Speed/acceleration L _G	max.20[m/s]/max.200[m/s ²]
速度/加速度 L _A	Speed/acceleration L _A	max.3[m/s]/max.6[m/s ²]
滑行速度/加速度	Gliding speed/acceleration	max.12[m/s]/max.50[m/s ²]
材料-允许温度 °C	Material-permitted temperature	Reinforce PA/-40°C ~ +125°C
阻燃等级, 增强尼龙	Flammability Class, Reinforce PA	UL94-HB

K2N.32-K2W.32 拖链-产品规格范围

K2N.32-K2W.32 Cable Chain-Product specificationst

K2N.32-K2W.32 拖链—侧横杆可打开 K2N.32-K2W.32 Cable Chain-Crossbar along the inner or the outer radius can be opened

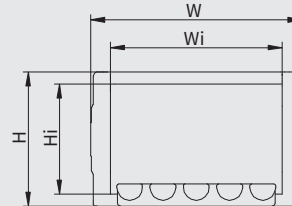

产品代码结构
Part Number Structure

K2W.3250*R*L*n

- 数量 (Quantity)
- 拖链长度 (Length of Cable chains)
- 弯曲半径 (Bending Radius)
- 内宽 (Inner Width)
- 型号 (Type)

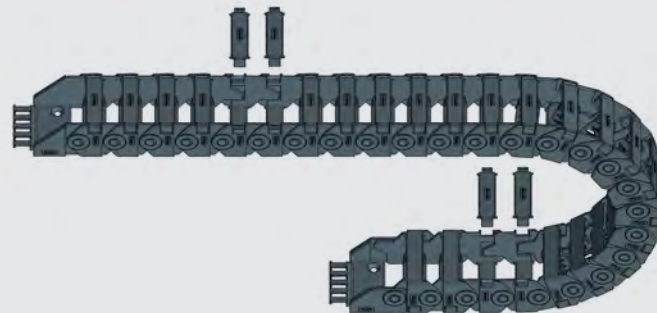

型号 Type	弯曲半径<R> Bending radius	内高<H _i > Inner height	内宽<W _i > Inner width	外高<H> Outer height	外宽<W> Outer Width	备注 Remark
K2N.32 38	mm (in.)	mm (in.)	mm (in.)	mm (in.)	mm (in.)	内开
K2W.32 38	48/63/75/100	32 (1.26)	38 (1.50)	39 (1.54)	49.4 (1.94)	外开
K2N.32 50	/125		50 (1.97)		61.4(2.42)	内开
K2W.32 50			50(1.97)		61.4 (2.42)	外开

订货范例 Order details **K2W.3238* R48 *1000mm* 2**

R	H _L	D	K	P
mm (in.)	mm (in.)	mm (in.)	mm (in.)	mm (in.)
48 (1.89)	135 (5.31)	113(4.45)	211.72 (8.34)	30.5 (1.20)
63 (2.48)	165 (6.50)	128(5.04)	258.82 (10.19)	30.5 (1.20)
75 (2.95)	189 (7.44)	140(5.51)	296.5 (11.67)	30.5 (1.20)
100 (3.94)	239 (9.41)	165(6.50)	375 (14.76)	30.5 (1.20)
125 (4.92)	289 (11.38)	190(7.48)	453.5 (17.85)	30.5 (1.20)

K2N.32-K2W.32 拖链-拖链接头 K2N.32-K2W.32 Cable Chain-Mounting Bracket

塑料接头或钢制接头 Plastic Or Steel Mounting Bracket

- 双侧独立式塑料接头或钢制接头 · Independent plastic or steel mounting brackets at both ends
- 两侧接头可选择性转动角度 · Optional rotation angle for the mounting brackets at both ends
- 耐腐蚀&耐摩擦 · Anti-corrosion, Rub-resistance
- 可提供预装配件形式 · Available preassembly form
- 可实现内外连接 · Realizable Internal and external connection



可选配的接头安装方式 Available installation methods

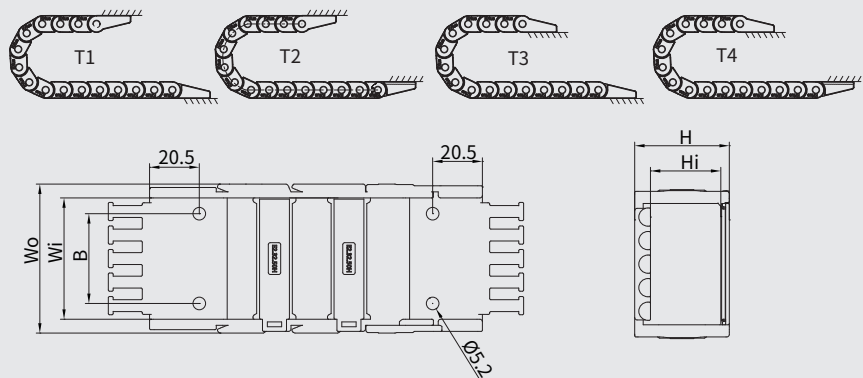

拖链型号 Type	其他编码 Other Code	W0尺寸 Dimension W0	B尺寸 Dimension B
	主体 Main Body	K210120	mm (in.)
K2N.32 38	主体 Main Body	K211234	49.4 (1.94)
K2W.32 38	接头 Mounting Bracket	K210309	25 (0.98)
K2N.32 50	横杆 Crossbar	K211235	49.4(1.94)
K2W.32 50	横杆 Crossbar	K211236	25(0.98)
	横杆 Crossbar	K210226/27	61.4(2.42)
	横杆 Crossbar		37(1.46)

产品代码结构 Part Number Structure

K2W.3238+B+n	K2W.32*B*T1*n	两端接头 On both brackets
— 安装方式 (Installation Methods)	K2W.32*f*T1*n	固定端接头 Fixed bracket
— 两端接头 (On Both Brackets)	K2W.32*m*T1*n	活动端接头 Moving bracket
— 内宽 (Inner Width)		
— 型号 (Type)		

★ 每款拖链的接头都有所不同, 订购时如有任何疑问, 请及时咨询科瑞斯。
Every bracket is different, please contact us if you have any question.

K2N.32-K2W.32 拖链-隔离片 K2N.32-K2W.32 Cable Chain-Separator

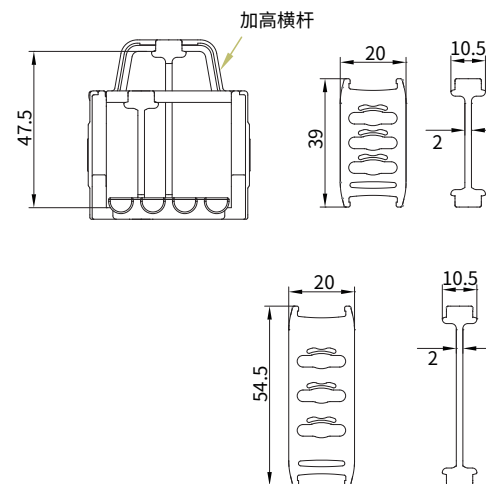

- 本款拖链可供选配的隔离片为竖隔片, 可以实现垂直分隔
- 竖隔片的数量可以根据客户的实际需求进行配备, 可以每隔一个链节装一个, 也可以每隔一个链节装几个, 客户可任意配备
- 竖隔片安装完成后, 可以根据线缆排布进行滑动
- Vertical separators are available to choose which can make the vertical division
- Vertical separators can be placed into each link or different quantity links, it can be customized
- Separators can be moved for different cable